

REV.	DESCRIPTION	DRAWN	CHECKED	APPROVED
A	NEW RELEASE	YCH 03/24/09	~	

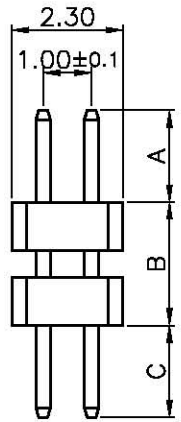

NOTES:

- MATERIAL
  - INSULATOR:PA-46(UL 94V-0).
  - CONTACT MATERIAL:COPPER ALLOY.
- SPECIFICATION
  - CURRENT RATING:1.0 Amp.
  - INSULATION RESISTANCE:500MΩ Min.
  - DIELECTRIC WITHSTANDING:600VAC.
  - CONTACT RESISTANCE:20mΩ Max.
  - OPERATING TEMPERATURE:-45°C TO+110°C.
- PART NUMBER: DS1031-21
- PRODUCT NUMBER CODE:  
 DS1031-21 - X X X X X X  
 DIM.A B TYPE  
 1: TYPE 1  
 MOUNTING TYPE  
 V: VERTICAL TYPE  
 HOUSING COLOR  
 B:BLACK  
 CONTACT PLATING  
 8: FULL GOLD FLASH  
 CONNECTOR TYPE  
 P:PLUG  
 No.OF CONTACTS  
 2\*2-2\*40

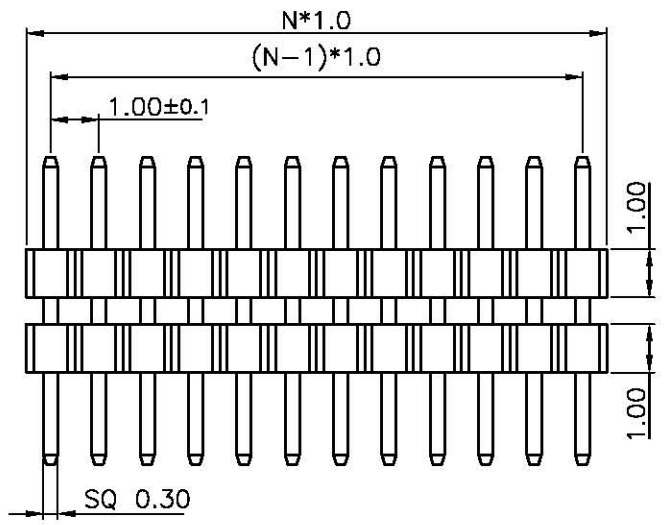
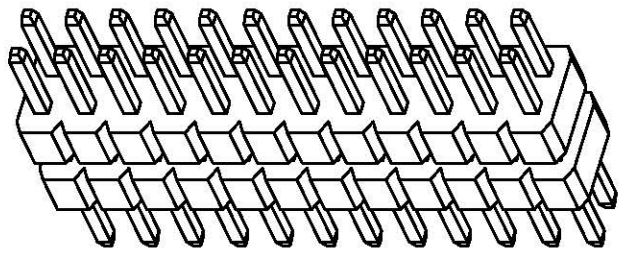
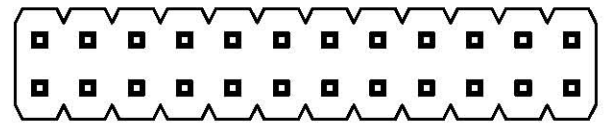

TYPE	DIM A	DIM B	DIM C
1	1.90	2.55	1.90
2			
3			
4			
5			
6			
7			
8			
9			
10			

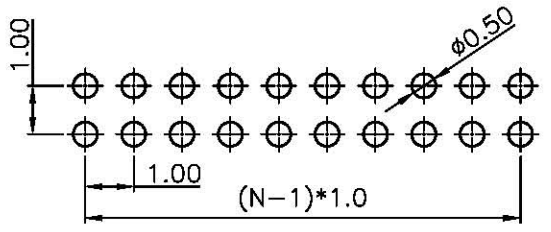

RECOMMEND PCB LAYOUT(TOLERANCE=±0.05)

GENERAL TOLERANCE		ANGLE TOLERANCE		PROJECTION		TITLE	DUAL ROW PIN HEADER
X.	±0.60	X.	±5°	UNITS	mm	PITCH 1.0mm STACK V/T TYPE	
.X	±0.38	.X	±3°	SHEET SIZE	A4	SERIES	DS1031-21 SERIES
.XX	±0.25	.XX	±2°				
DRAWING TYPE		CUSTOMER					
SCALE		1:1	SHEET	1 OF 1			
DRAWING NO.		C-DS1031-21-XXXXXX					