

REV.	DESCRIPTION	DRAWN	CHECKED	APPROVED
A	NEW RELEASE	YCH 03/17/08'	~	

N:NUMBER OF CONTACTS

NOTES:

- ELECTRICAL CHARACTERISTICS:
 - CONTACT RESISTANCE: 20mΩ Max.
 - DIELECTRIC WITHSTANDING VOLTAGE: 500V AC(rms) FOR 1 MINUTE.
 - INSULATION RESISTANCE: 1000MΩ Min.
- ENVIRONMENT CHARACTERISTICS:
 - TEMPERATURE RANGE: -45°C~+110°C.
- PRODUCT NUMBER CODE:

DS1021-02- X X X X

TABLE A & DIM. TYPE
1: TYPE 1

CONTACT PLATING
F1: FULL GOLD FLASH
6: TIN

MOUNTING TYPE
V: V/T TYPE
No. OF CONTACTS
1*1~1*40
2*2~2*40

TABLE A:

TYPE	Dimension	
	A	B
1	4.50	14.50
2		
3		
4		
5		
6		

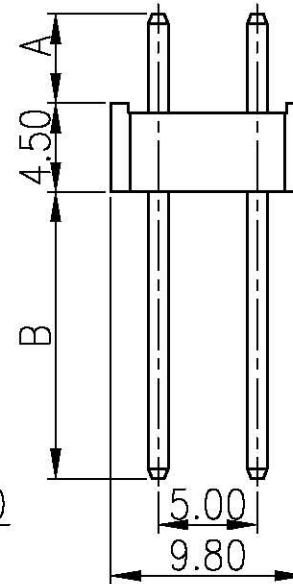
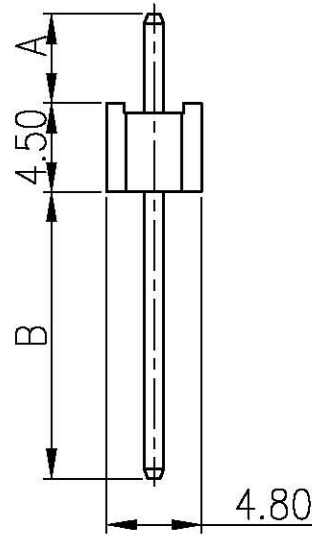
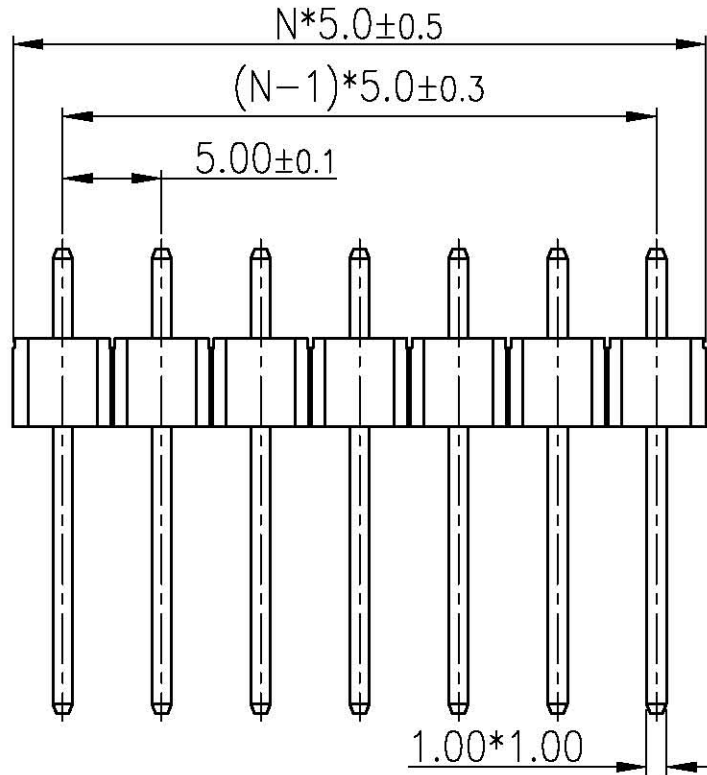
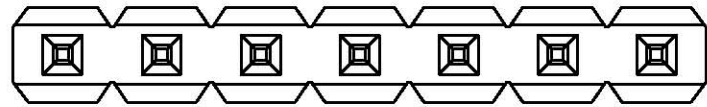

GENERAL TOLERANCE		ANGLE TOLERANCE		PROJECTION	TITLE
X.	±0.60	X.	±5°		PIN HEADER PITCH 5.00mm V/T TYPE
.X	±0.38	.X	±3°	mm	
.XX	±0.25	.XX	±2°	SHEET SIZE	A4 SERIES DS1021-02 SERIES
DRAWING TYPE	CUSTOMER				
SCALE	1:1	SHEET	1 OF 1		
DRAWING NO.	C-DS1021-02-XXXX				