

REV.	DESCRIPTION	DRAWN	CHECKED	APPROVED
A	NEW RELEASE	LJH 03/30/06'	~	LJC 03/30/06'
B	整理图纸	YCH 10/18/10'	~	

- NOTES:
- ELECTRICAL CHARACTERISTICS:
 - CONTACT RESISTANCE: 20mΩ Max. INITIAL.
 - DIELECTRIC WITHSTANDING VOLTAGE: 500V AC(rms) FOR 1 MINUTE.
 - INSULATION RESISTANCE: 1000MΩ Min.
 - ENVIRONMENT CHARACTERISTICS:
 - OPERATING TEMPERATURE: 0°C~+85°C.
 - STORAGE TEMPERATURE: -20°C~+70°C.
 - PART NUMBER: DS1004
 - PRODUCT NUMBER CODE:
 DS1004 - X X X
 CONTACT TYPE
 1: TYPE 1 3: TYPE 3
 2: TYPE 2 4: TYPE 4
 CONTACT PLATING
 F1: Full GOLD FLASH
 No.OF CONTACTS
 1*1 - 1*40
 2*1 - 2*40

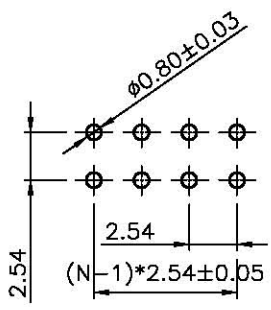
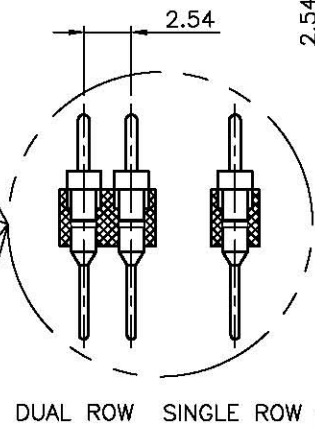
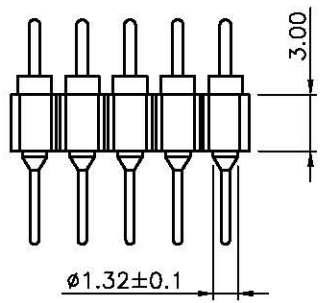
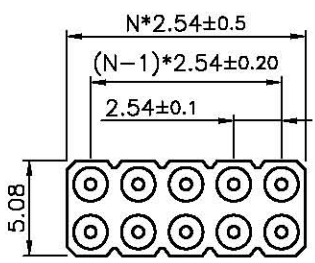
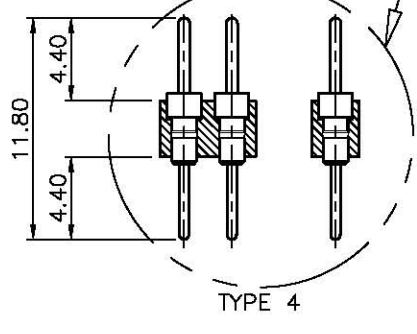
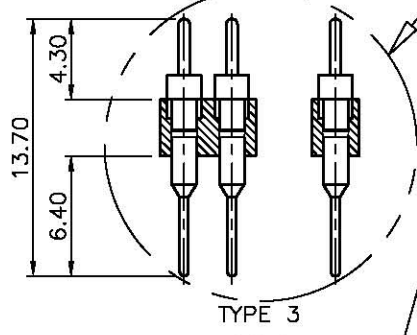
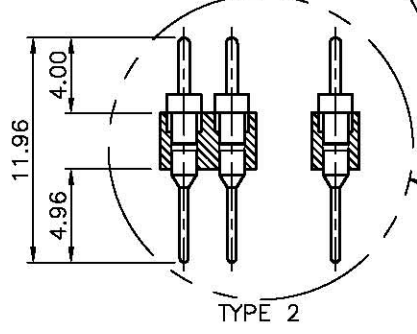
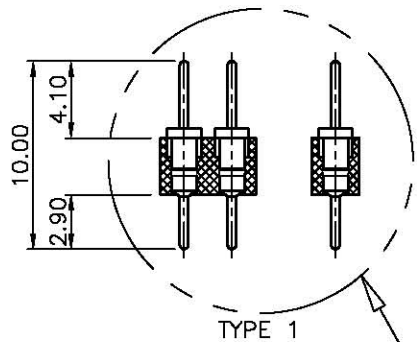

RECOMMEND PCB LAYOUT
(TOLERANCE=±0.05)

TYPE1/2/3/4 DIA. (TOLERANCE=±0.05)

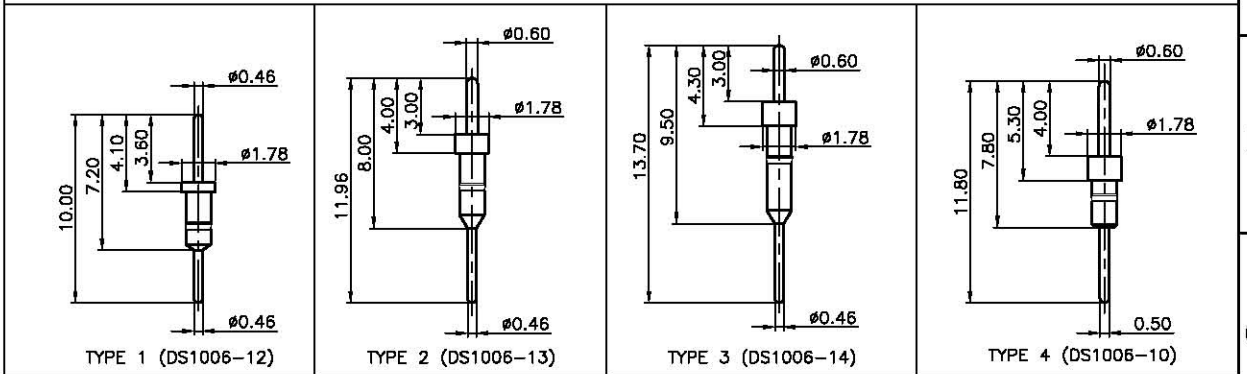

GENERAL TOLERANCE		ANGLE TOLERANCE		PROJECTION	TITLE	DIP STRIP ADAPTER PITCH 2.54mm	
X.	±0.60	X.	±5°	UNITS		mm	SHEET SIZE
.X	±0.38	.X	±3°	SHEET SIZE	A4	SERIES	DS1004 SERIES
.XX	±0.25	.XX	±2°	广东中南电子电器有限公司 http://www.zn-cn.com			
DRAWING TYPE		CUSTOMER					
SCALE	1:1	SHEET	10F1				
DRAWING NO.		C-DS1004-XXX					