

TYPE 1

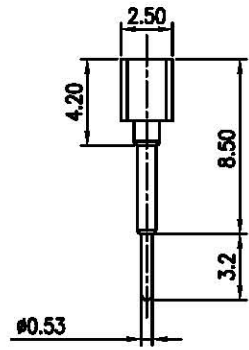

TYPE 2

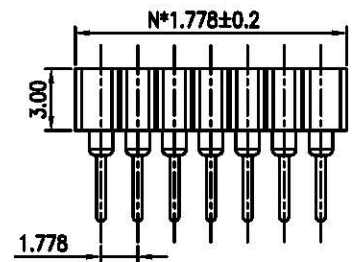
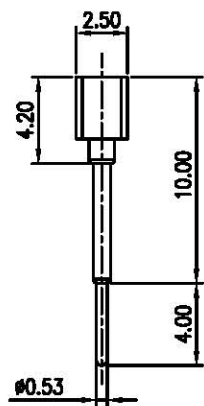
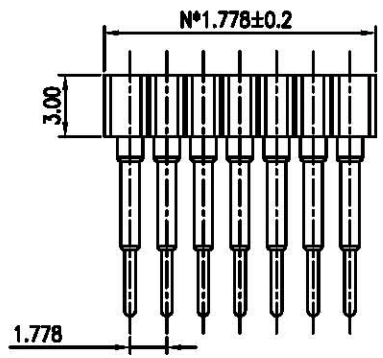

TYPE 3

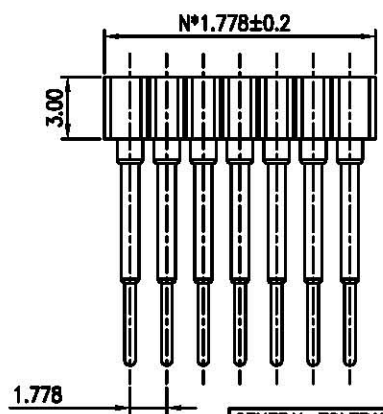

REV.	DESCRIPTION	DRAWN	CHECKED	APPROVED
A	NEW RELEASE	LL 06/30/06'		

NOTES:

- ELECTRICAL CHARACTERISTICS:
  - CONTACT RESISTANCE: 20mΩ Max.
  - DIELECTRIC WITHSTANDING VOLTAGE: 500V AC(rms) FOR 1 MINUTE.
  - INSULATION RESISTANCE: 1000MΩ Min.
- ENVIRONMENT CHARACTERISTICS:
  - OPERATING TEMPERATURE: 0°C~+85°C.
  - STORAGE TEMPERATURE: -20°C~+70°C.

3. PRODUCT NUMBER CODE:

DS1002-10 - X X X X

- Contact type
  - TYPE 1
  - TYPE 2
  - TYPE 3
- Clip plating
  - Tin 150u"
  - Tin 200u"
  - G/F
  - Gold 3u"
  - Gold 10u"
  - Gold 15u"
- Pin plating
  - Tin 150u"
  - Tin 200u"
  - G/F
  - Gold 3u"
  - Gold 10u"
  - Gold 15u"
- No. of contacts
 

06 08 14 16 18  
20 24 28 32 40
- Series No.  
DS1002-10

GENERAL TOLERANCE		ANGLE TOLERANCE	
X.	±0.60	X.	±5°
.X	±0.38	.X	±3°
.XX	±0.25	.XX	±2°

PROJECTION		TITLE	SIP IC SOCKET PITCH 1.778mm
UNITS	mm	SHEET SIZE	A4
SHEET SIZE	A4	SERIES	DS1002-10 SERIES

2	CONTACT		COPPER ALLOY	GOLD PLATED	DRAWING TYPE	CUSTOMER		
1	HOUSING		THERMOPLASTIC	UL 94 V-0	SCALE	1:1	SHEET	1 OF 1
ITEM	PART NAME	PART NO.	MATERILAS	FINISHED	DRAWING NO.	C-DS1002-10-XXXX		

广东中南电子电器有限公司

www.zn-cn.com